

① Board dimensions (top view)  
Scale 3:1

② Connector callouts (bottom view)  
Scale 3:1

③ Isometric view  
Scale 3:1

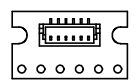
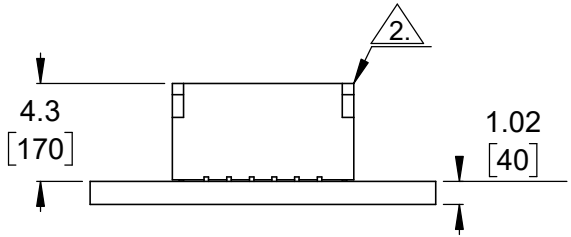

④ Profile  
Scale 3:1

⑤ Actual size  
Scale 1:1

- $\triangle$  1. Intended for #2 or M2 screws.
- $\triangle$  2. Top-entry, 6-pin male JST SH-type connector.
- 3. To get the specified scale, select 100% in print settings.
- 4. Drill location tolerance:  $\pm 0.1$  [ $\pm 5$ ].
- 5. Board edge tolerance:  $\pm 0.3$  [ $\pm 10$ ].

<a href="https://www.pololu.com/product/4770">https://www.pololu.com/product/4770</a>	
Name: Breakout for JST SH-Style Connector, 6-Pin Male Top-Entry	Item number: 4770, 4771
Drawing date: 29 September 2020	Dev code: con01a
Units: mm [mil]	Material: mixed



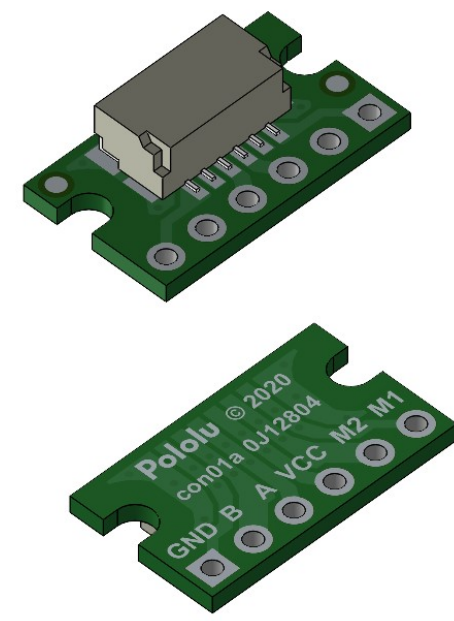
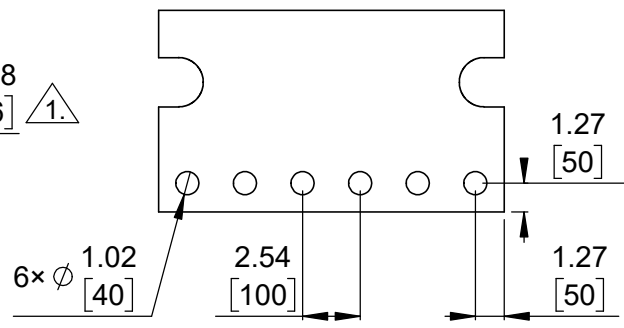
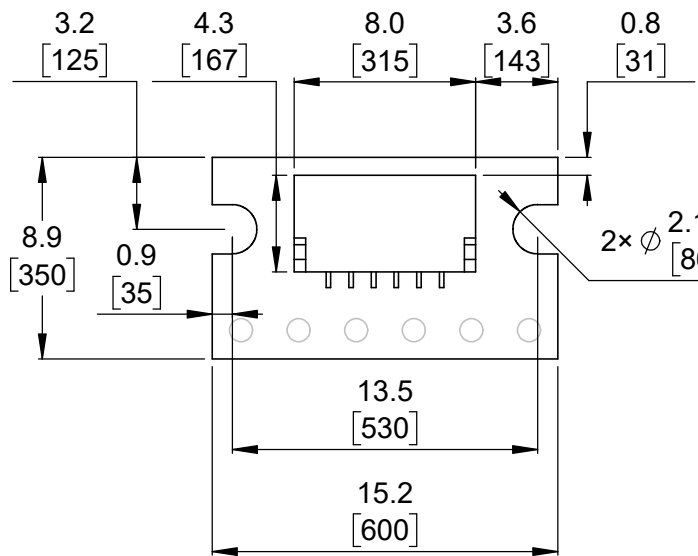

1 Board dimensions (top view)  
Scale 3:1

2 Connector callouts (bottom view)  
Scale 3:1

3 Isometric view  
Scale 3:1

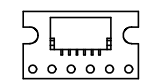
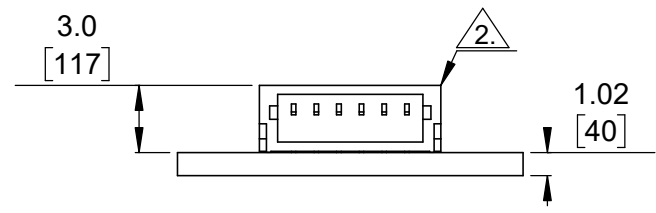

4 Profile  
Scale 3:1

5 Actual size  
Scale 1:1



1. Intended for #2 or M2 screws.



2. Side-entry, 6-pin male JST SH-type connector.

3. To get the specified scale, select 100% in print settings.

4. Drill location tolerance:  $\pm 0.1$  [ $\pm 5$ ].

5. Board edge tolerance:  $\pm 0.3$  [ $\pm 10$ ].

<https://www.pololu.com/product/4772>

Name: Breakout for JST SH-Style Connector, 6-Pin Male Side-Entry		Item number: 4772, 4773
Drawing date: 29 September 2020	Dev code: con01a	 © 2020 Pololu Corporation
Units: mm [mil]	Material: mixed	